

Clapham Junction Futures

March 2019



M
M
MOTT
MACDONALD

Hawkins
Brown

LAING O'ROURKE

Proposing a new vision for Clapham Junction Station

Mott MacDonald, Hawkins\Brown and Laing O'Rourke have undertaken a study to present a vision for the future of Clapham Junction, examining how an integrated approach to development can offer significant benefits to both the station and the wider Battersea area.

Following the Department for Transport's guidance on future Market Led Proposals published in March 2018, Mott MacDonald established a working group, comprising infrastructure experts including architects Hawkins\Brown and construction partners Laing O'Rourke to support the DfT's aspiration to increase investment in infrastructure through cross sector engagement.

Further enhanced by the impending arrival of Crossrail 2, the initiative identified Clapham Junction Station, as the busiest interchange in London with connectivity to central, regional and international transport hubs with unique potential for transformational regeneration that can respond to the need of the growing community and changing live/work patterns. Informed by the understanding that building a new station around an existing station is hugely complex and expensive, the team undertook the challenge to see how the investment in the station and the railway could also bring

value to the local community as well as the rail passengers.

The case study has analysed key objectives in order to develop an enhanced station with resilient capacity for future growth and a masterplan for Battersea facilitating active forms of travel through wider public realm improvements to meet the growing commuter demands, improve passenger experience, safety and accessibility.

Harbinder Birdi, Partner and Head of Infrastructure at Hawkins\Brown said:

"As our cities become more polycentric, transport hubs are emerging as centres of vibrant mixed-use development that contribute to the sustainable growth of cities. By becoming more efficient with how we use this land we can connect communities currently separated by infrastructure, create new connections and unlock development sites to drive new revenue streams. Transport governing bodies increasingly recognise these and are turning to their land to generate revenue and new sources of income. The opportunity is particularly evident at Clapham Junction where there is genuine need to reconnect the social divide between the local communities north and south of the railway while contributing towards London's growing housing and economic infrastructure needs."

Ian Watkins, Project Director at Mott MacDonald said:

"We are seeing a growing requirement to regenerate and expand the infrastructure of our UK cities tied into the bigger question we all need to answer; how do we build sustainable cities in the future? In this context development opportunities, over and around transport hubs, have enormous potential to transform the landscape of our cities. Creating new neighbourhoods around transport hubs is a key ingredient to ensure UK cities are equipped to handle population growth, new ways of living and working, encouraging modal shift and reducing commuting. Clapham Junction has the potential to become a blueprint for a compact, mixed-use interchange hub that is more an extension of high street and public realm and less a gate line defined station concourse"

Phil Robinson, Civil Engineering Leader for Laing O'Rourke's Engineering Excellence Group said:

"This is a once in a lifetime opportunity for transformation at Clapham Junction, providing significant benefits to both the local community and the wider transport network. The intertwined nature of the transport and urban realm improvements required, create the exciting prospect of delivering this as a single coordinated project, utilising offsite manufacturing techniques to accelerate construction and reduce disruption within the surrounding community."

Meet the project team



Roger Hawkins
 Founding Partner
 Hawkins\Brown
 rogerhawkins@hawkinsbrown.com



Harbinder Birdi
 Partner, Head of Infrastructure Sector
 Hawkins\Brown
 harbinderbirdi@hawkinsbrown.com



Marko Neskovic
 Partner
 Hawkins\Brown
 markoneskovic@hawkinsbrown.com



Kosh Kar
 Associate
 Hawkins\Brown
 koshkar@hawkinsbrown.com



David Eastland
 Project Principal
 Mott MacDonald
 david.eastland@mottmac.com



Clare Wildfire
 Global Practice Leader,
 Cities
 Mott MacDonald
 clare.wildfire@mottmac.com



Cathy Travers
 General Manager, Built Environment
 Mott MacDonald
 cathy.travers@mottmac.com



Oliver Steele
 Project Director
 Mott MacDonald
 oliver.steele@mottmac.com



Ian Watkins
 Project Principal
 Mott MacDonald
 ian.i.watkins@mottmac.com



Lydia Fenny
 Project Manager
 Mott MacDonald
 lydia.fenny@mottmac.com



Jason Tobin
 Head of Work Winning European Hub
 Laing O'Rourke
 jtobin@laingorourke.com



Philip Robinson
 Civil Engineering Leader
 Laing O'Rourke
 probinson@laingorourke.com

Benefits



Railway

- Enhanced user experience
- Improved safety and accessibility
- Increased Capacity
- More Stopping Services
- 21st century station



Onward Travel

- Integration of CRL 2
- Enhanced Multi-Modal Interchange
- Enhanced Cycling Infrastructure
- Prioritised Pedestrian Access



Town Centre

- A New Town Centre for Battersea
- Extension of the High Street
- Maximised Reuse of Rail Lands
- Integrates with existing urban context



Housing

- 5000+ New Homes
- Affordable Housing
- Shared Live-work Spaces



Jobs

- 5000+ New Jobs
- New Commercial Property
- New Studio/Light Industrial Space



Social Benefits

- Improved Links Across the Railway
- Improved Access to Green Spaces
- Improved Access to Jobs
- Enhanced community infrastructure

Proposed St John's Hill Station Entrance

Extending the public realm.

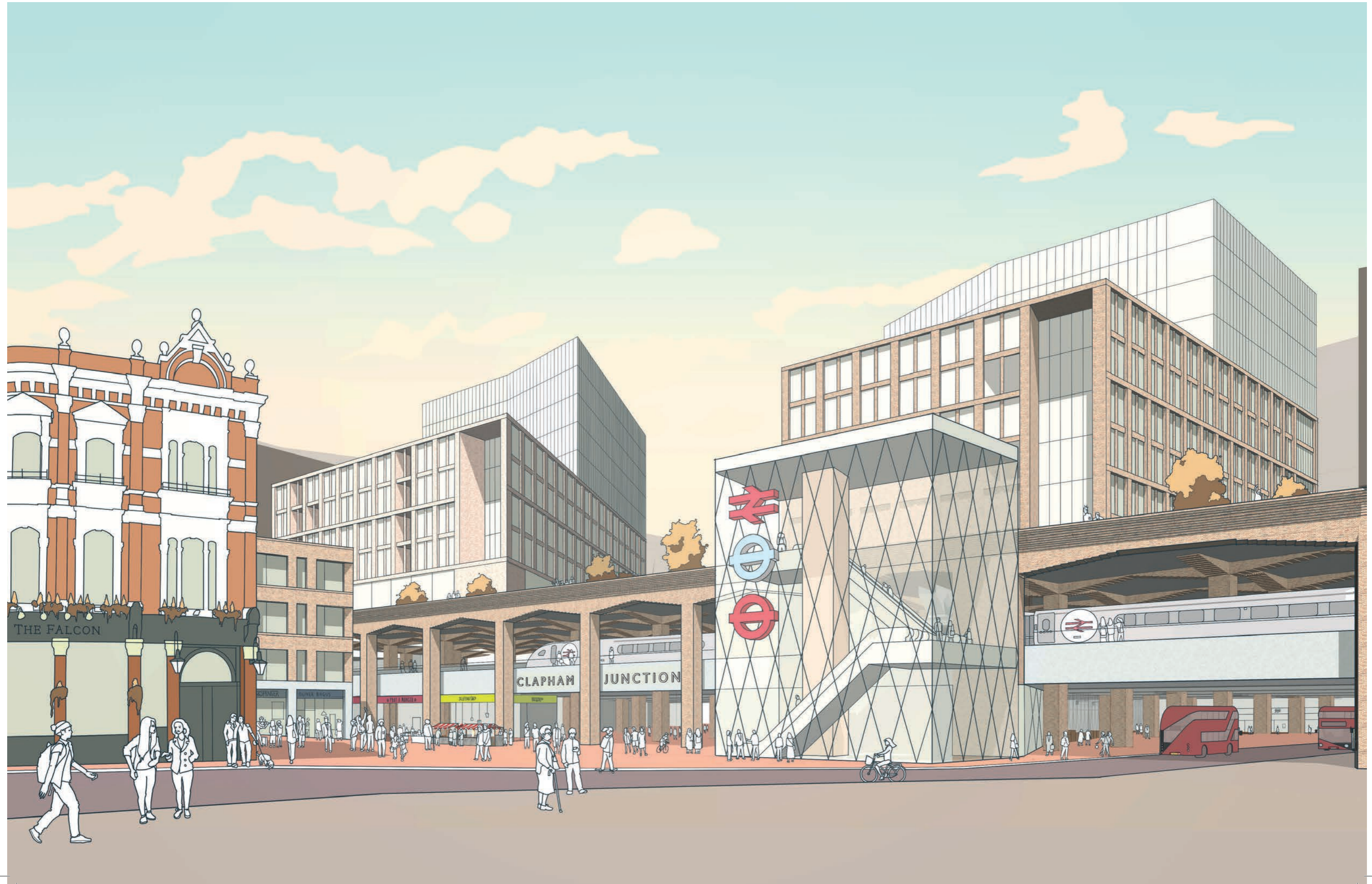

Concourse Layout Strategy

A compact transport interchange hub.

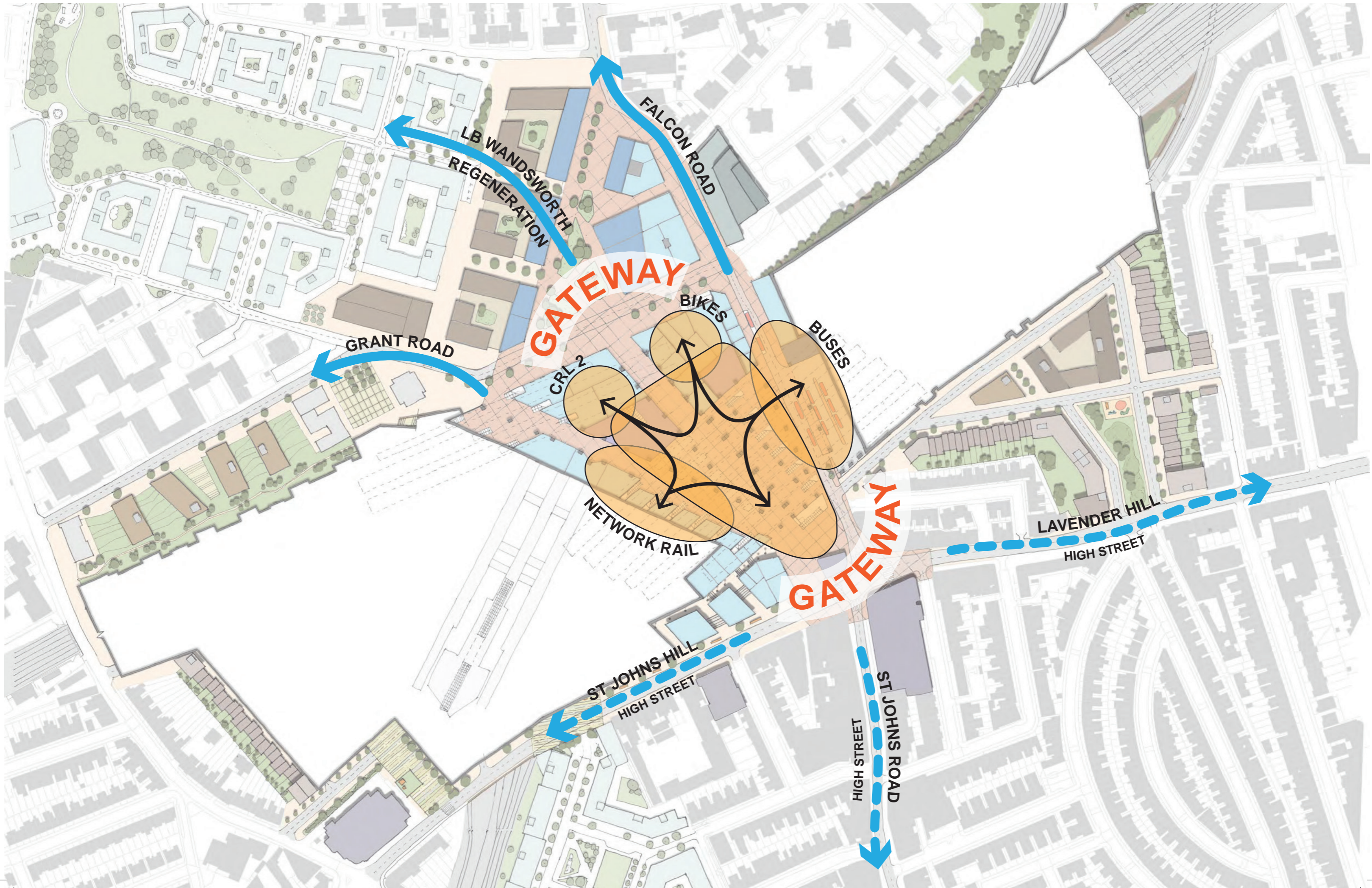

Illustrative Concourse Layout

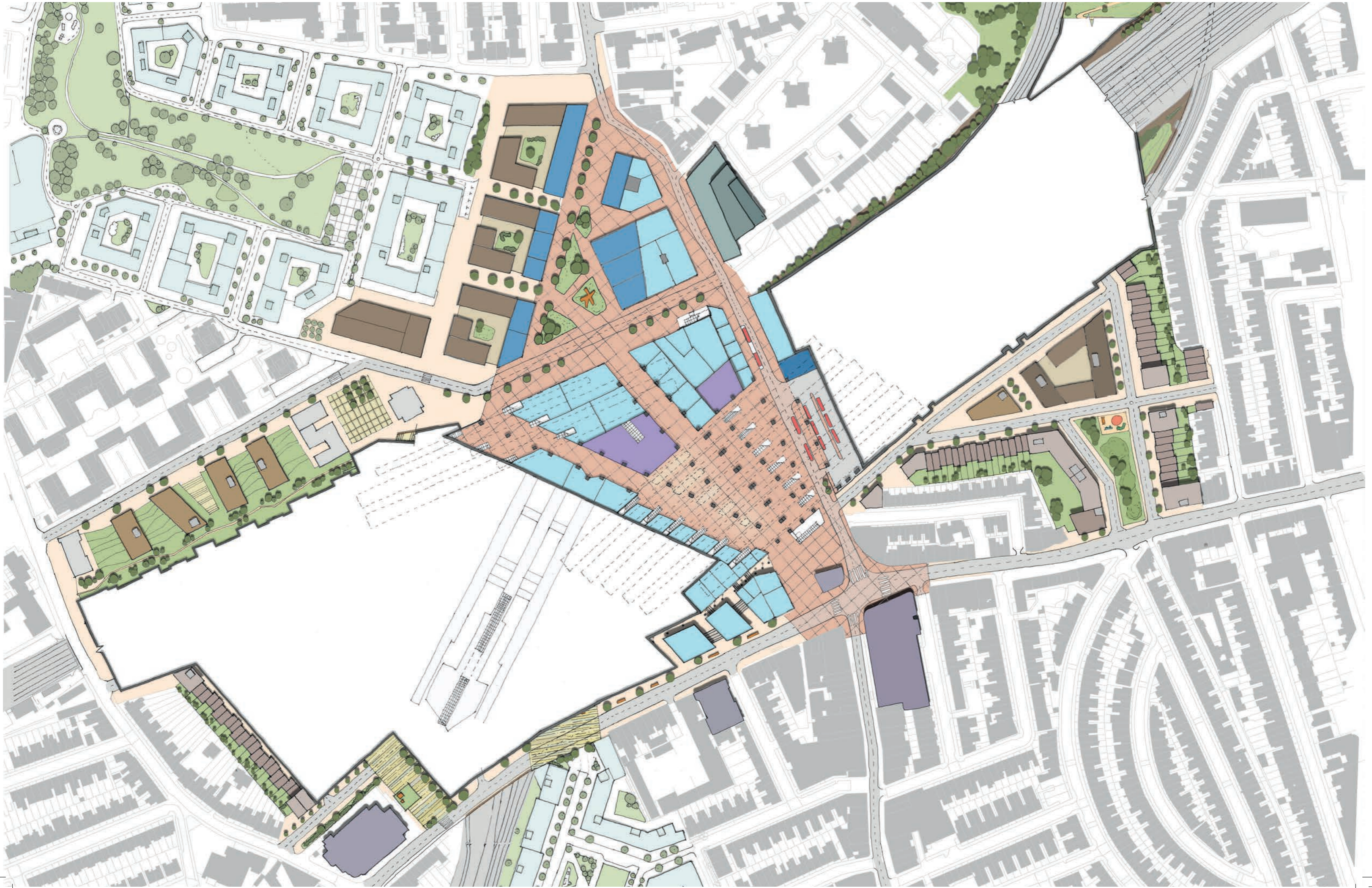

Illustrative Platform Layout

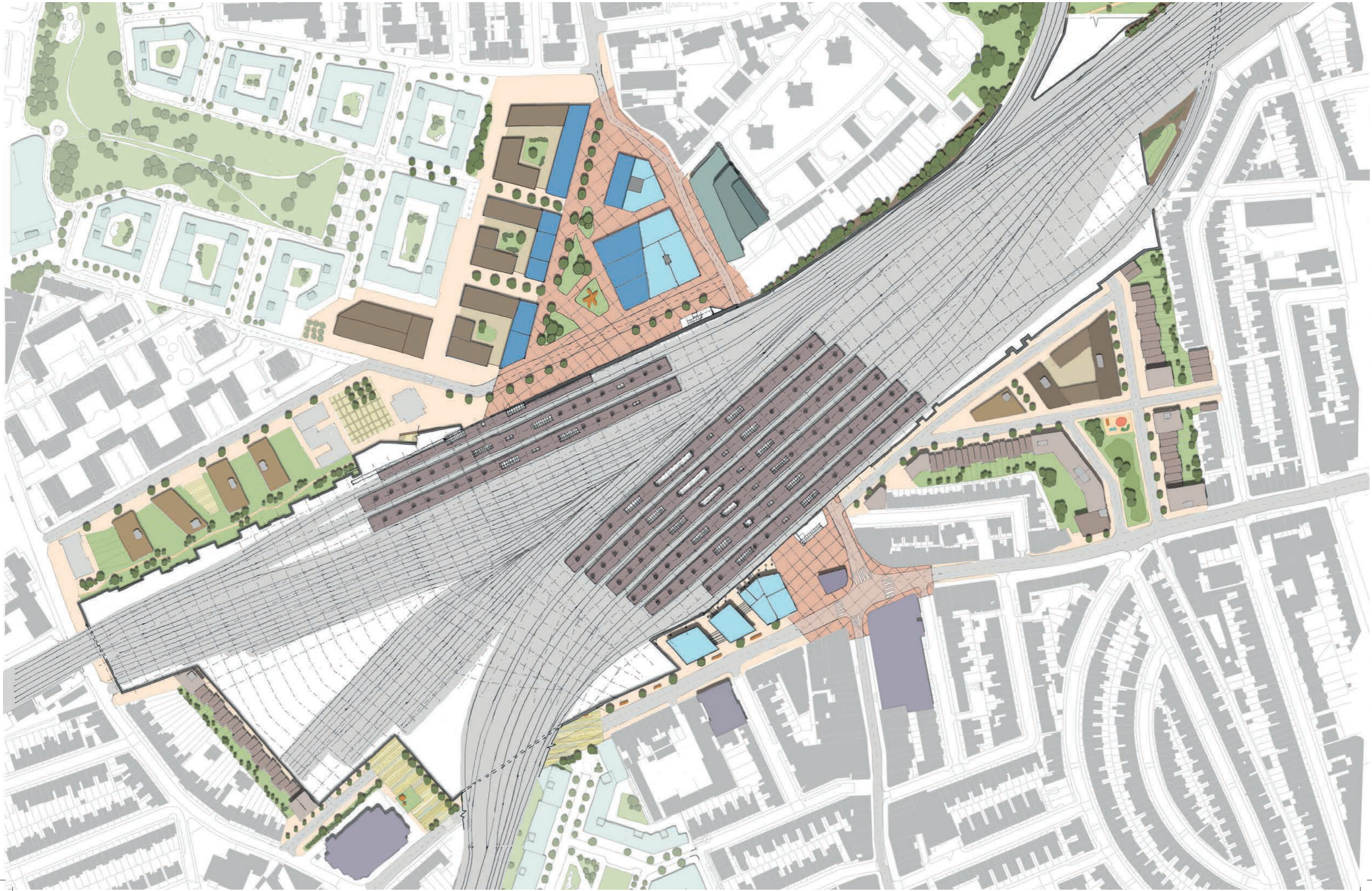

Framework Layout Strategy

Mixed use town centre regeneration.

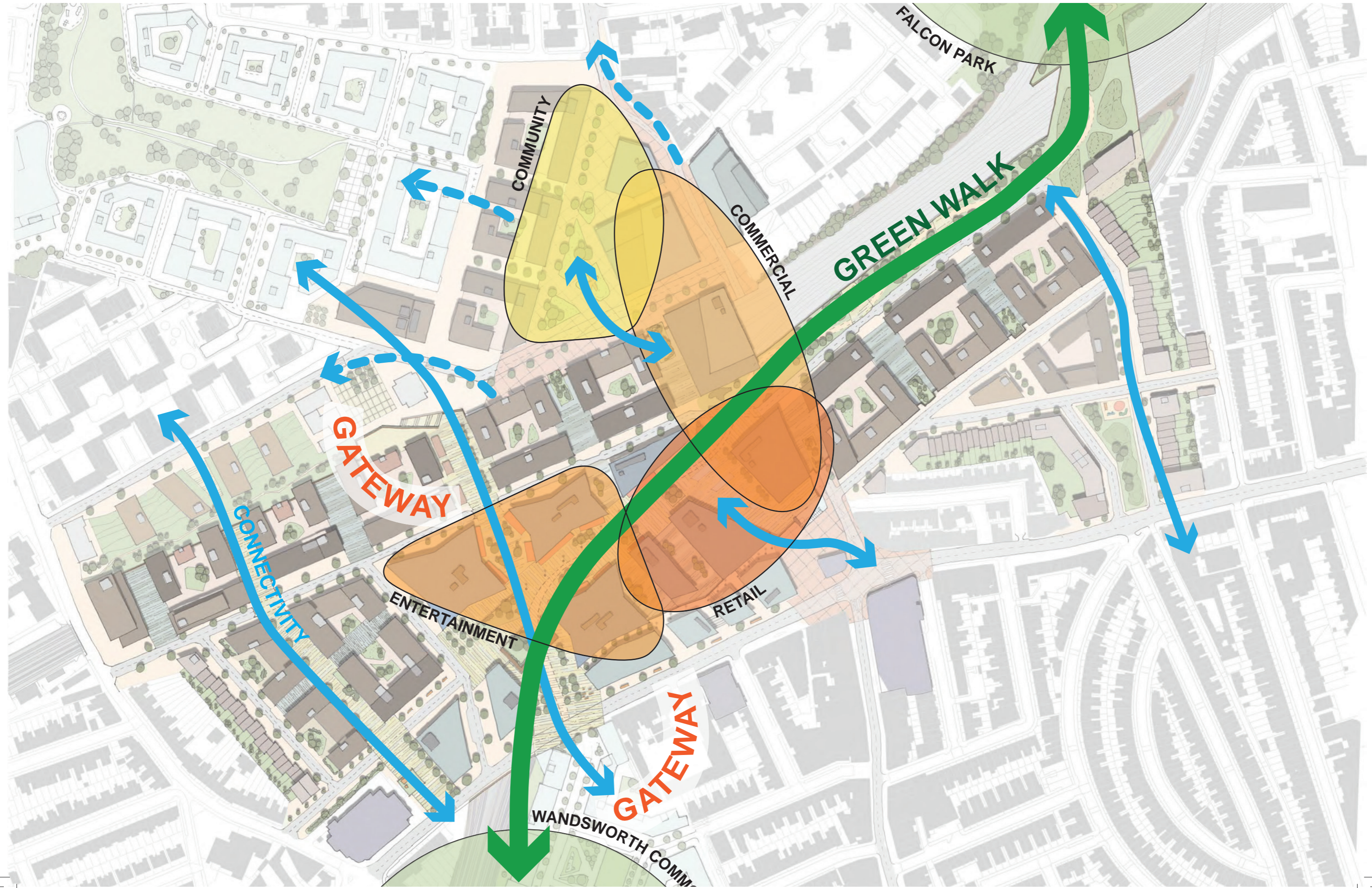

Illustrative masterplan layout

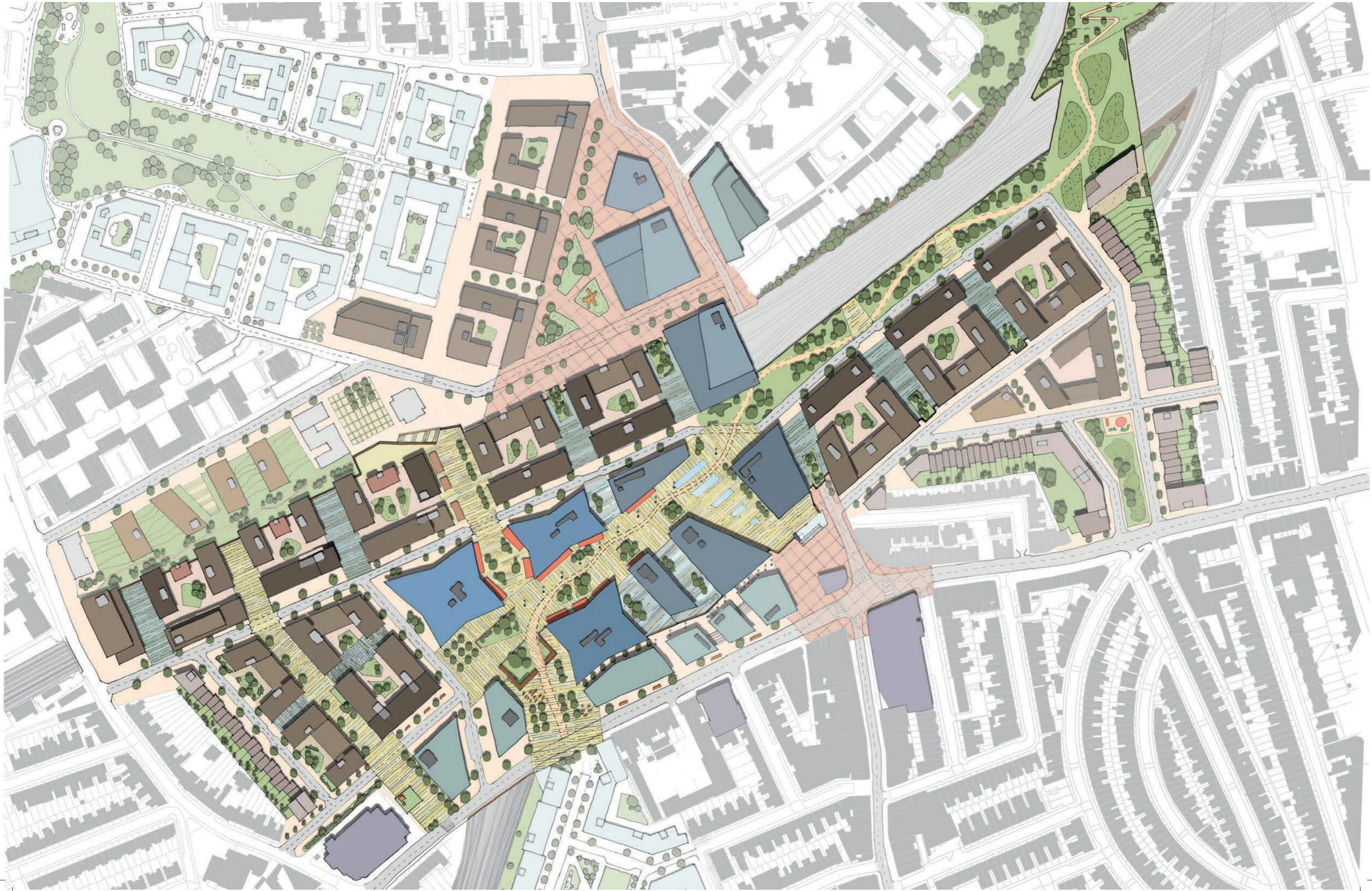

Illustrative Concourse Section

Connecting the community.

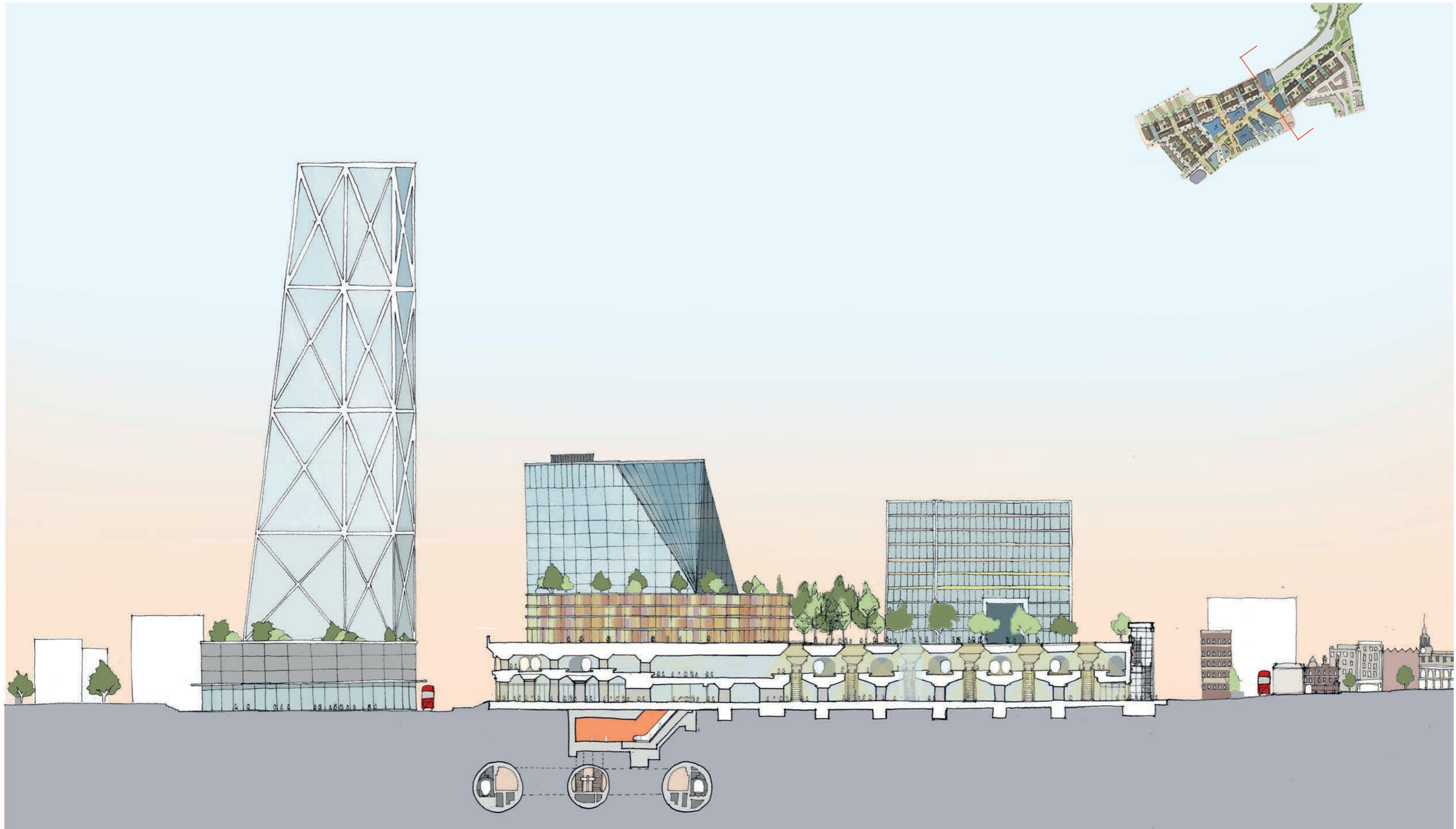

Illustrative Brighton Yard Section

Connecting the community.

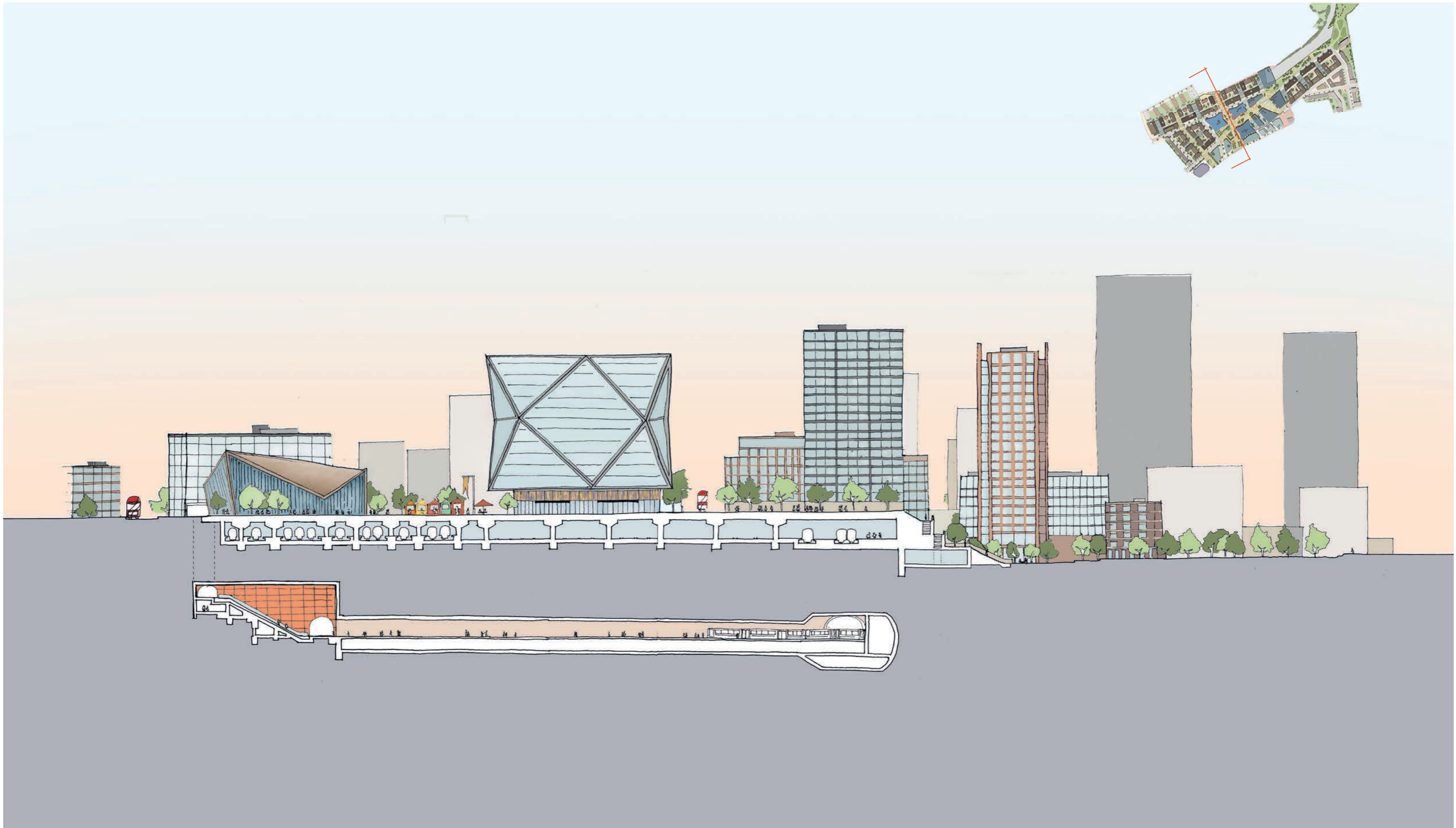

Garden View

Mediating level change. Terraced landscapes provide pedestrian access up from Grant Road.

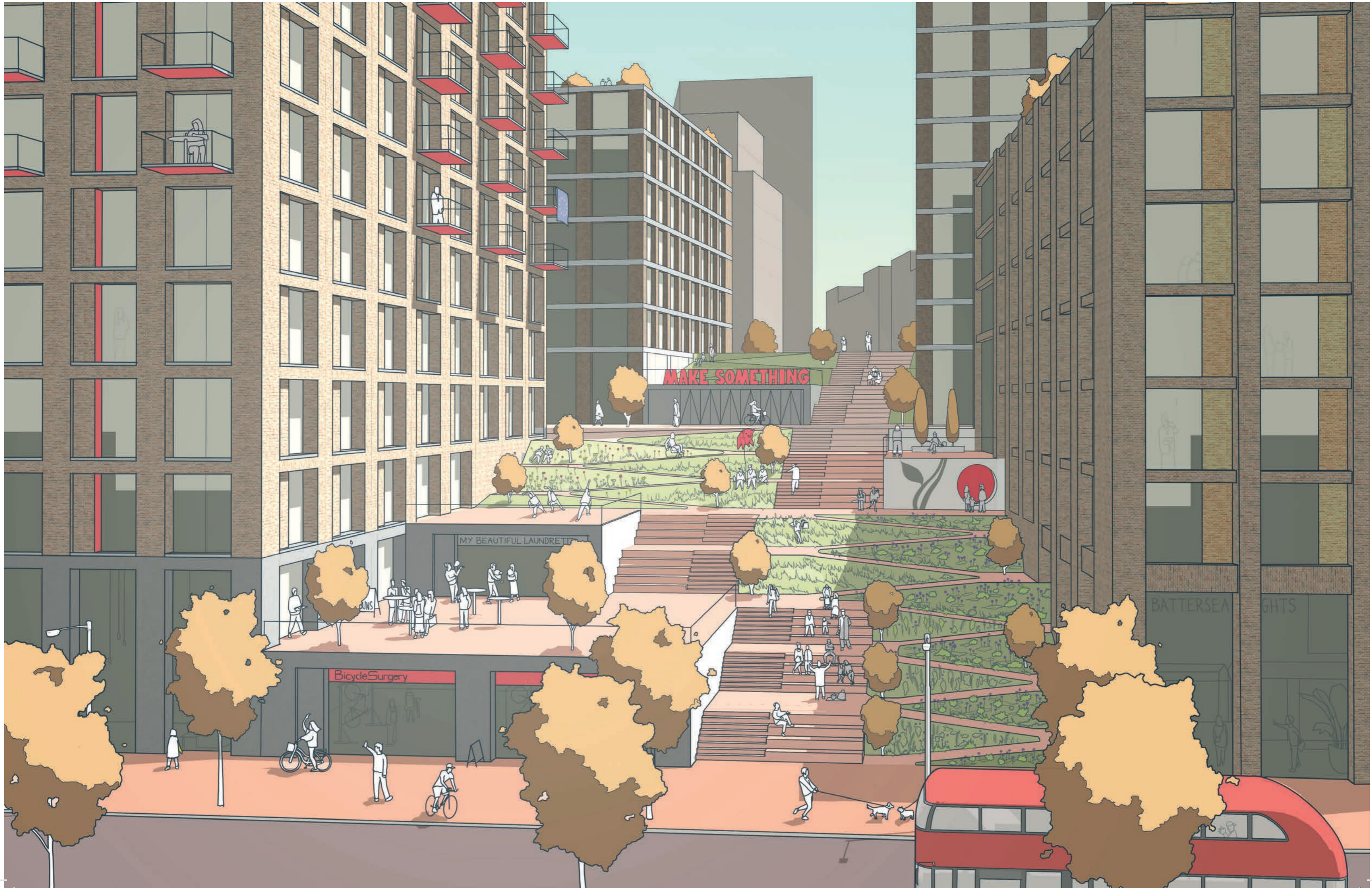

Exploded Axonometric

Illustrative section showing integration of the town centre and transport hub components.

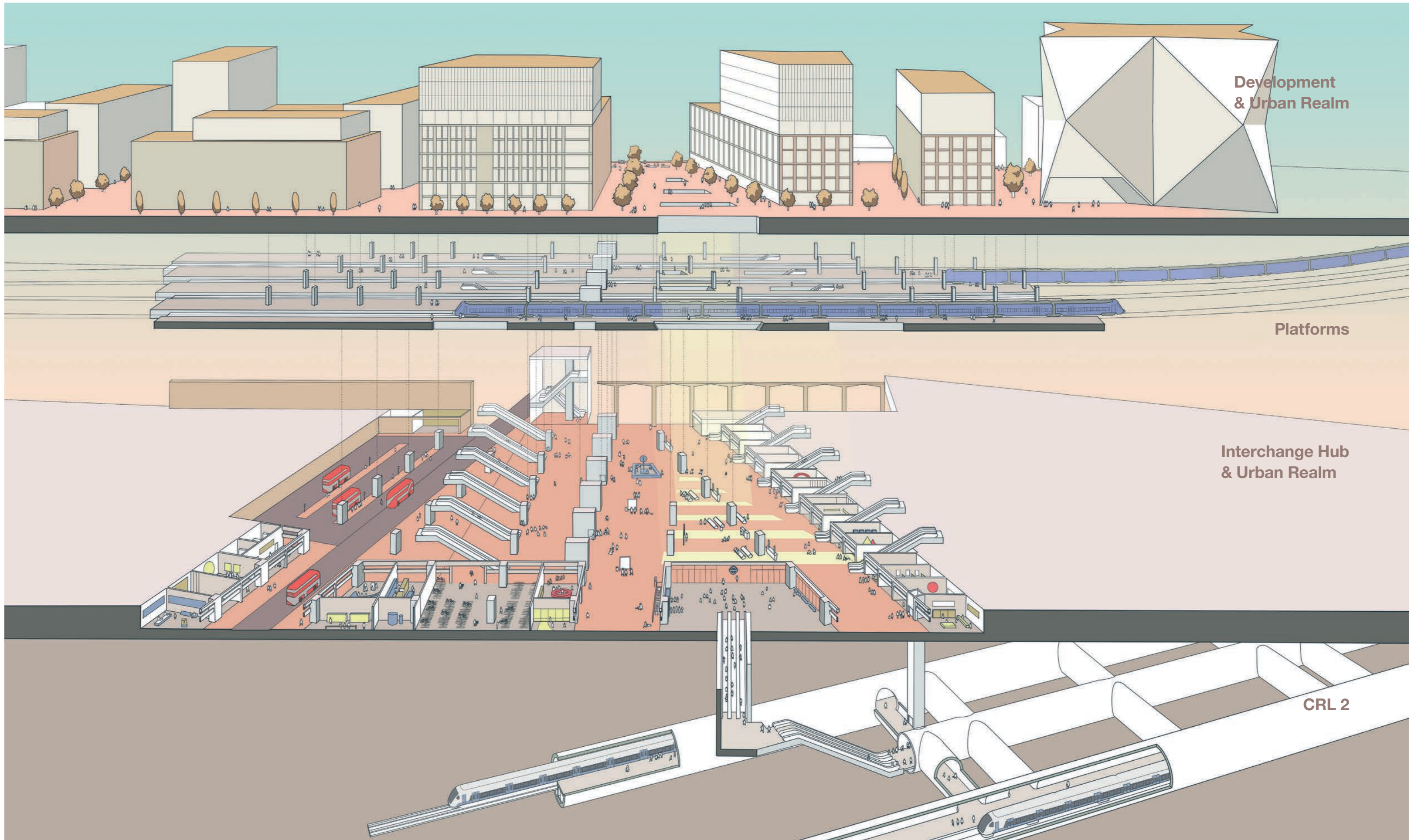

Overview

Clapham Junction Futures



#claphamjunctionfutures



Mott MacDonald
10 Fleet Place,
London
EC4M 7RB

T: +44 (0) 207 651 0300
E: london@mottmac.com
W: <https://www.mottmac.com/cities/>



Hawkins\Brown
159 St John Street
London
EC1V 4QJ

T +44 (0)20 7336 8030
E: mail@hawkinsbrown.com
W: www.hawkinsbrown.com



Laing O'Rourke
Engineering Excellence Group
Bridge Place, Anchor Boulevard
Crossways, Dartford, Kent
DA2 6SN

T: +44 (0) 1322 296 200
E: <http://www.laingorourke.com/contact-us/contact-us.aspx>
W: www.laingorourke.com